

NIST PMI Test Models - 2012

Test Model 5

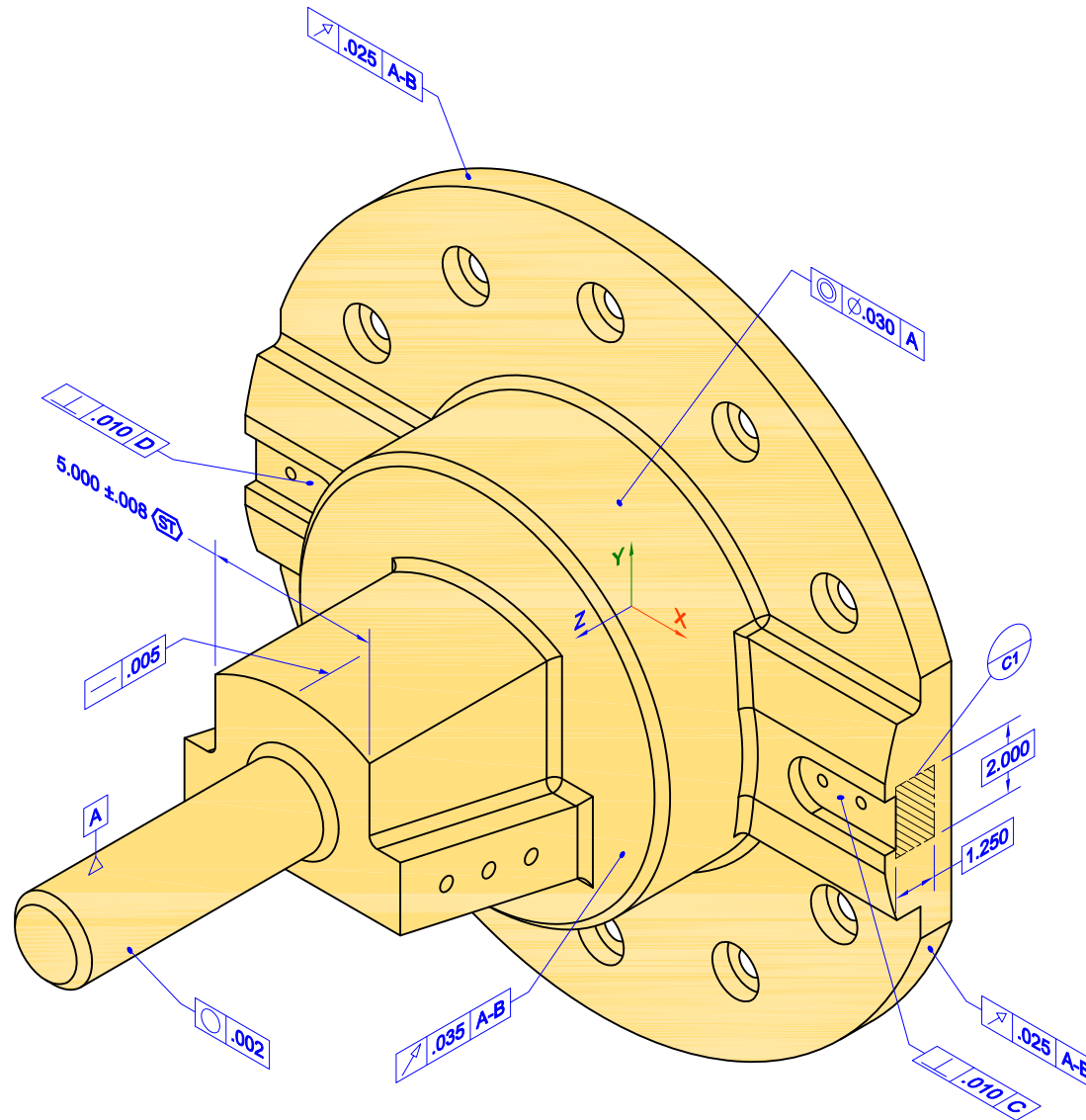

Notes
Datum feature B and
Datum target D1 defined
in View 2 (of 2).

PMI Complex Test Case 5 - View 1 (of 2)
Includes Atomic Test Cases - 11, 18, 19, 23, 24, 37, 42, 44

Rev D

nist_ctc_05_asme1_rd

NIST PMI Test Models - 2012

Test Model 5

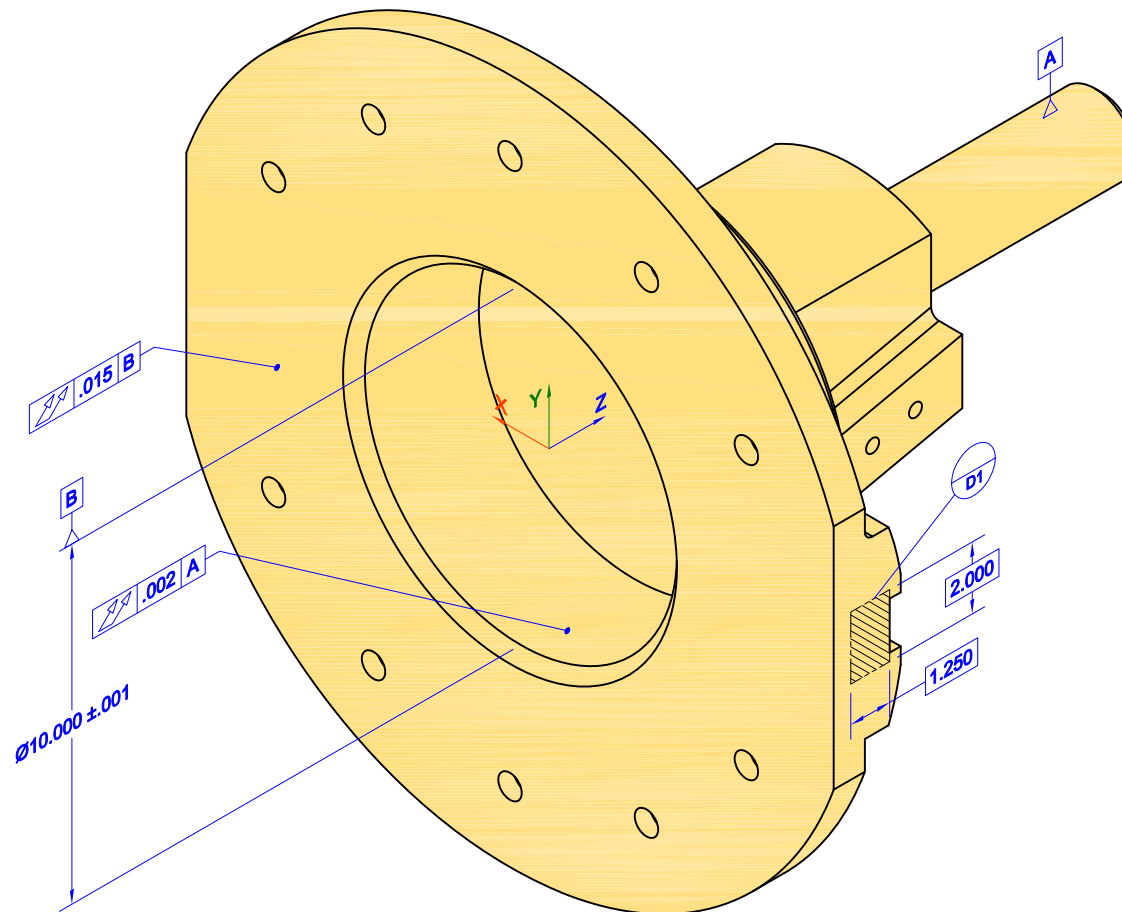

Notes

Datum feature A defined in View 1 (of 2).

Datum target D1 referenced in View 1 (of 2).

PMI Complex Test Case 5 - View 2 (of 2)
Includes Atomic Test Cases - 25, 38, 42

Rev D

nist_ctc_05_asme1_rd